

**ITEM OPPORTUNITY SYNOPSIS:**



Supplier Scouting Number

<b>TECHNICAL INFORMATION:</b>	<b>1. Describe the item:</b>	
		<b>Please describe the item application/ the end use of item.</b>
	<b>Provide the item number <u>if applicable</u>: (N95 Mask vs Protective Mask).</b>	
	<b>2. Summary of Technical Specifications and Performance Requirements:</b>	<b>a. Provide dimensions / size / tolerances / performance specifications for the item.</b>
		<b>b. List required materials needed to make the product, Including materials of product components, if applicable.</b>
		<b>c. Are there applicable certification requirements to supply this item? (i.e. ISO certification) Are there any applicable regulations that apply to the production of this item? (i.e. FDA regulations or EPA regulations) Are there any other standard requirements? (i.e. ASME Standard, IEEE Standard) Please specify.</b>
	<b>d. Describe the manufacturing processes (elaborate to provide as much detail as possible).</b>	
<b>f. Additional Comments:</b>		
<b>Is there other information that would impact the item's performance or usefulness? Please explain.</b>		

<b>BUSINESS INFORMATION:</b>	<b>Potential Business Volume Estimate (i.e., # Units Per Day, Month, Year):</b>				
	<b>Target Price / Unit Cost Information:</b>				
<b>Delivery Requirements:</b>	<b>When is it needed by? (Immediate, 30 Days, 6 months, etc.)</b>				
	<b>Describe packaging requirements (i.e., individually/ group packaging).</b>				
	<b>Where is this opportunity located? Is there a preferred shipping proximity - if applicable?</b>				
<b>Additional Comments:</b>	<b>How long would you like to leave this opportunity open to the National Network?</b>				
	<input type="checkbox"/> 3 days	<input type="checkbox"/> 5 days	<input type="checkbox"/> 7 days	<input type="checkbox"/> 10 days	<input type="checkbox"/> Other
	<b>Is there other information you would like to include?</b>				

Photos or diagrams of the item (helpful but not required).

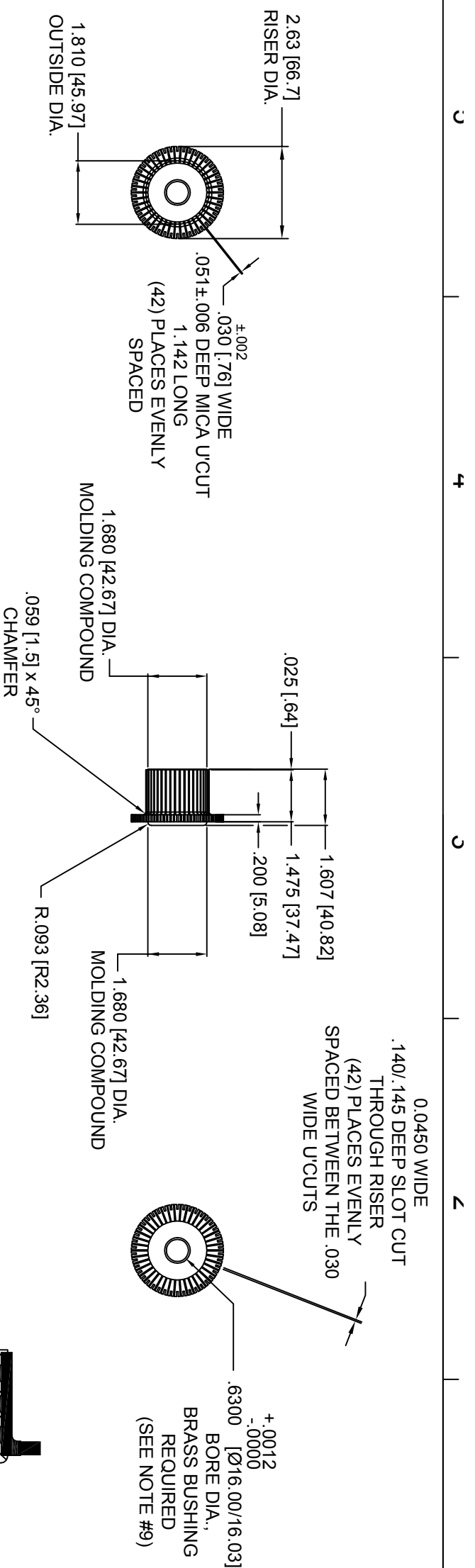

**NOTES:**

1. 42 BAR MICA MOLDED COMMUTATOR.
2. O.D. TO BE CONCENTRIC TO I.D. WITHIN .005.
3. ENDS TO BE PERPENDICULAR TO BORE WITHIN .005.
4. ELECTRICAL TEST BAR TO BAR @ 250 VOLTS.
5. ELECTRICAL TEST BAR TO GROUND @ 2,000 VOLTS.
6. SPIN TEST @ 25,000 RPM @ 350°F FOR 30 SECONDS.
7. MAX. BAR SKEW - .010.
8. MAX. BAR MOVEMENT - .0002.
9. MAX. DISTORTION - .0005.
9. COMMUTATOR DESIGN MUST ACCEPT OTHER BORE DIAMETERS; AS LISTED, FOR FUTURE DESIGNS.
10. TOTAL OF .078 (2 MM) MIN. INSULATION BETWEEN COMMUTATOR SEGMENTS (BARS) AND STEEL BUSHING OR SHAFT BETWEEN LIVE PARTS AND DEAD METAL BY HITACHI CHEMICAL OF JAPAN (#CP-7010)
11. THE MODEL# AND THE MANUFACTURER OF THE COMMUTATOR SUPPORT USED (SEE NOTE 10); MUST BE LABELLED ON THE OUTSIDE OF THE BOX.
12. MATERIAL CERTIFICATIONS ARE REQUIRED WITH EACH SHIPMENT. MATERIAL SPECS AVAILABLE UPON REQUEST.

**2X SCALE**

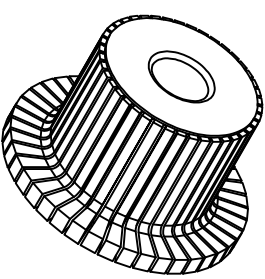

UNLESS OTHERWISE SPECIFIED:  
 TOLERANCES:  
 FRACTIONAL: ± 1/64"  
 ANGULAR: ± 30°  
 ONE PLACE DECIMAL: ± .020"  
 TWO PLACE DECIMAL: ± .010"  
 THREE PLACE DECIMAL: ± .005"  
 PROPRIETARY AND CONFIDENTIAL  
 THE INFORMATION CONTAINED IN THIS DRAWING IS THE SOLE PROPERTY OF CURRENT APPLICATIONS. ANY REPRODUCTION IN PART OR AS A WHOLE WITHOUT THE WRITTEN PERMISSION OF CURRENT APPLICATIONS IS PROHIBITED.

NAME	DATE
BB	5/6/19
CHECKED	
DATE STAMP	

WWW.CURRENTAPPS.COM

275 BELLEVUE AVENUE SOUTH  
 WATERTOWN, NY 13601  
 PHONE: (315) 788-4689  
 FAX: (315) 788-4693

TITLE: **42 BAR MICA MOLDED COMMUTATOR**

REV	ECN	NEW ISSUE	BY	DATE	CHKD	PROJECT NUMBER	1383	PART USED ON MODEL NUMBER	MATERIAL	TITLE	42 BAR MICA MOLDED COMMUTATOR	SIZE	DWG. NO.	48442-02	REV	A
A	2581	NEW ISSUE	BB	6/25/19								A			A	
REVISION RECORD												SCALE: 1:1	WEIGHT:		SHEET 1 OF 1	