

## ITEM OPPORTUNITY SYNOPSIS

<b>Scouting Number:</b>	2024-099
<b>Name of the item to be scouted:</b>	Shoe Insert
<b>State item to be used in:</b>	Rhode Island

### Describe the Item:

<p>Please describe the item application/the end use of the item.</p>	<p>3-in-1 polyurethane open or closed cell shoe insert crafted to tackle various challenges frequently encountered by wearers of athletic footwear. Its primary functions include diminishing creases that develop in shoes, neutralizing unpleasant odors, and absorbing moisture resulting from sweat and environmental conditions. The product is geared towards elevating the comfort, longevity, and overall freshness of athletic shoes for users. It is intended to be placed in both shoes after wear and left in until the next use, ensuring continuous effectiveness. Polyurethane foam will act as a holder for the odor absorbing pellets/pouch and moisture absorbing dessicant pack. Open cell preferred but closed cell acceptable.</p>
--	---

### Supplier Information:

<b>Type of Supplier Being Sought (select from the list below):</b>	
Manufacturer	x
Contract Manufacturer	
Distributor	
Other (Please Specify)	
<b>Reason for Scouting Submission (select from the list below)</b>	
2nd Supplier	
Price	
Re-Shore	
Past supplier no longer available	
New Product Startup	x
BABA	
Other (Please Specify)	

### Summary of Technical Specifications and Performance Requirements:

<p>Describe the manufacturing processes (elaborate to provide as much detail as possible)</p>	<p>Create a one up mold for the foam components. Cut and over molded and insert the nylon strap in to the rear of the foam piece (strap is used to pull the foam insert out of the shoe). The product includes an overmolded strap. I am open to design changes that could simplify the manufacturing process (though the general concept will stay the same). I am thinking about the overmolded strap for example.</p>
<p>Provide dimensions / size / tolerances / performance specifications of the item</p>	<p>- 120mm by 83.4mm by 50mm (provided photo as well) for the foam insert - The pouch is approximately 46mm wide x 95mm long x 20mm (highest point in the center)</p>
<p>List required materials needed to make the product, including materials of product components, if applicable</p>	<p>We are open to ideas, but we think foam and nylon strap</p>
<b>Are there applicable certification requirements?</b>	
Yes	
No	x
Please explain:	
<b>Are there any applicable regulations that apply to the production of this item?</b>	
Yes	
No	x
Please explain:	
<b>Are there any other standards / requirements?</b>	
Yes	
No	x
Please explain:	
<b>NAICS 1</b>	315990 Apparel Accessories and Other Apparel Manufacturing
<b>NAICS 2</b>	

### Additional Comments:

<b>Additional technical comments:</b>	
<b>Volume and Pricing:</b>	
<b>Estimated Potential Business Volume (i.e. #units per day, month, year):</b>	We are still in the prototype/sample run stage so looking for a small sample run. Once design is finalized, looking to produce 1,000 units for commercial feedback.
<b>Estimated Target Price/Unit Cost Information:</b>	Target price \$2 for full product. Looking for a quote on this/willing to discuss.
<b>Delivery Requirements:</b>	
<b>When is it needed by? (Immediate, 30 days, 6 months, etc.)</b>	ASAP
<b>Describe packaging requirements (i.e. individually/group packaging, etc.)</b>	2 foam pieces per package (one for each shoe)
<b>Where will this item be shipped?</b>	Shipped to Providence, RI for the sample run. 1,000 units might be a different location depending on how long it takes to get through the sample run. Relocating in summer of 2024 come August.
<b>Additional Comments:</b>	
<b>Is there other information you would like to include?</b>	I am currently seeking a trial run for the production of a thousand parts, with the possibility of purchasing a smaller quantity of samples initially. While I am optimistic about the potential sales volume, it's important to note that this isn't a commitment to purchase parts outright, although a contract may be discussed later on. I am looking for an arrangement to iron out any kinks and gain a deeper understanding of the manufacturing process before proceeding to a larger production run for e-commerce sales, with retail expansion as a future goal. Ideally, I prefer domestic manufacturing and am currently based in Rhode Island. I am eager to share my personal story and how the product originated from my experiences as a student athlete. I would like to arrange a Zoom meeting to discuss further details and potentially visit the manufacturing facility to immerse myself in the process. Hoping we can make the product kid and animal friendly as well.



2

1

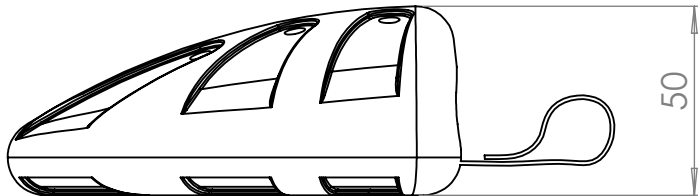
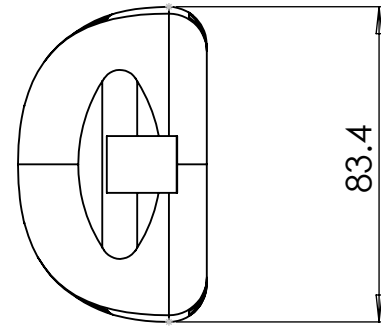
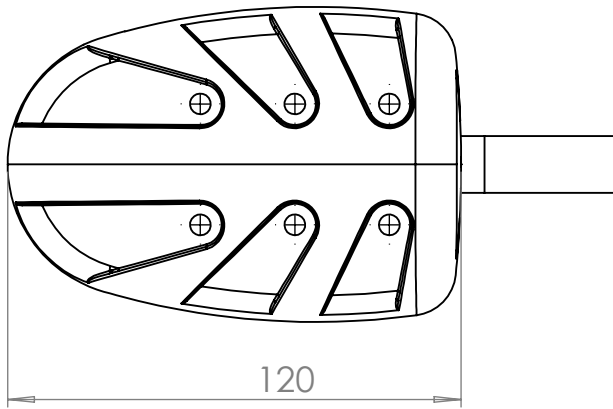

B

B

A

A

**PROPRIETARY AND CONFIDENTIAL**  
 THE INFORMATION CONTAINED IN THIS DRAWING IS THE SOLE PROPERTY OF <INSERT COMPANY NAME HERE>. ANY REPRODUCTION IN PART OR AS A WHOLE WITHOUT THE WRITTEN PERMISSION OF <INSERT COMPANY NAME HERE> IS PROHIBITED.

		UNLESS OTHERWISE SPECIFIED:		NAME	DATE
		DIMENSIONS ARE IN INCHES	DRAWN		
		TOLERANCES:	CHECKED		
		FRACTIONAL ±	ENG APPR.		
		ANGULAR: MACH ± BEND ±	MFG APPR.		
		TWO PLACE DECIMAL ±	Q.A.		
		THREE PLACE DECIMAL ±	COMMENTS:		
		INTERPRET GEOMETRIC TOLERANCING PER:			
		MATERIAL			
NEXT ASSY	USED ON	FINISH			
APPLICATION		DO NOT SCALE DRAWING			

TITLE: <b>Shoe Support</b>		
SIZE <b>A</b>	DWG. NO.	REV
SCALE: 1:2	WEIGHT:	SHEET 1 OF 1

2

1