

MEPNN Supplier Scouting Opportunity Synopsis

Section 1: General Information

Scouting Number	2024-343
Item to be Scouted	Cast Iron Lid and Rim
Days to be scouted	45
Response Due By	12/22/2024
Description	<p>We are seeking Ductile iron 12" OD lid and a ribbed structure (rim) to meet H20 load rating.</p> <p>We will send drawings without all final dimensions. Once we are in contact with a prospective manufacturer, we will be able to send finalized drawings.</p> <p>The intended application of this product is covering for groundwater containment.</p>
Notify Requester Immediately	
State item to be used in	North Carolina

Section 2: Technical Information

Type of supplier being sought	Manufacturer
Reason	Re-shore
Describe the manufacturing processes (elaborate to provide as much detail as possible)	Metal casting with 65-45-12 ductile iron, minimal machining may be required, finish with two color enamel paint
Provide dimensions / size / tolerances / performance specifications for the item	<p>12" OD with typical cast tolerances must meet H20 load rating. Please see attached documents for additional information.</p> <p>Part Number: 563980 is the lid component. Part Number 563982 is the rim component.</p>
List required materials needed to make the product, including materials of product components	Ductile iron 65-45-12
Are there applicable certification requirements?	No
Are there applicable regulations?	Yes
Details	Our products must meet H20 load rating to meet American Association of State Highway and Transportation Officials (AASHTO) standards.
Are there any other standards, requirements, etc.?	No
NAICS 1	424720 Petroleum and Petroleum Products Merchant Wholesalers (except Bulk Stations and Terminals)
NAICS 2	
Additional Technical Comments	

Section 4: Business Information

Estimated potential business volume	We are sourcing two separate parts. We produce roughly 5,675 units of each part per year, bringing our total to 11,150 total units for both parts. Currently importing roughly 1 million pounds of cast iron annually.
Estimated target price / unit cost information (if unavailable explain)	\$29.50 for lid and rim set after tariff and freight
When is it needed by?	We would like to see production quantities no later than 18 months.
Describe packaging requirements	Palletized, specific requirements to be determined in negotiation.
Where will this item be shipped?	Wilson, NC

Additional Comments

Is there other information you would like to include?

NOTE:

1. MATERIAL: GREY CAST IRON
2. COAT TOP OF LID WITH WHITE ENAMEL PAINT
3. COAT INNER TRIANGLE WITH BLACK ENAMEL PAINT AS SHOWN, AFTER WHITE PAINT HAS CURED
4. APPROXIMATE WEIGHT: 13.88 LBS

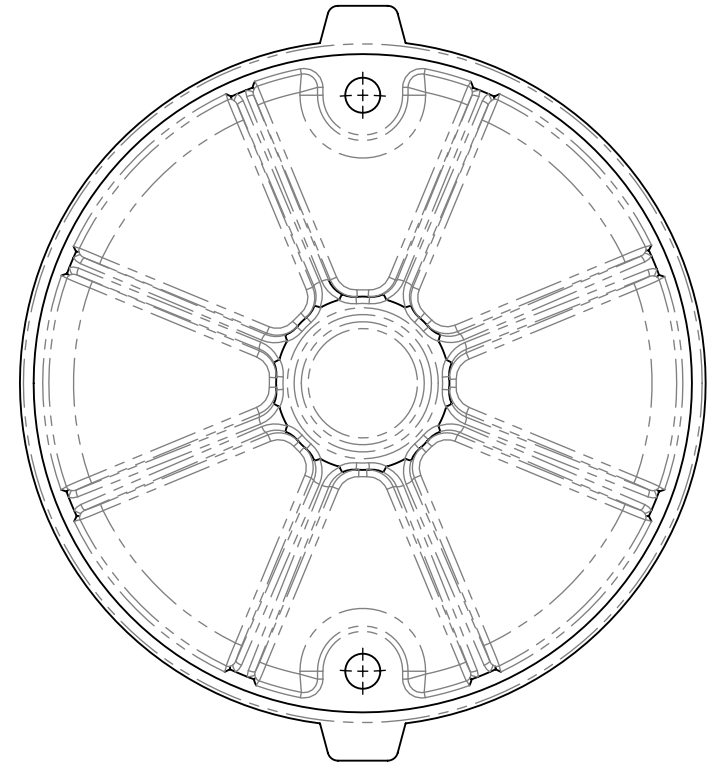
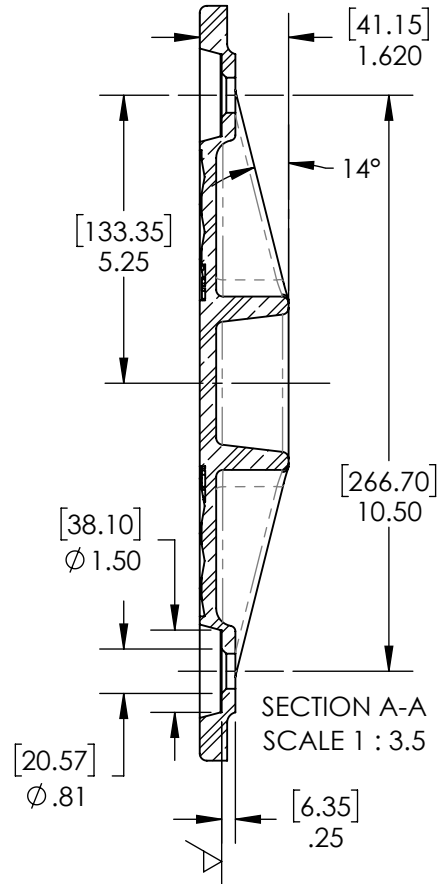
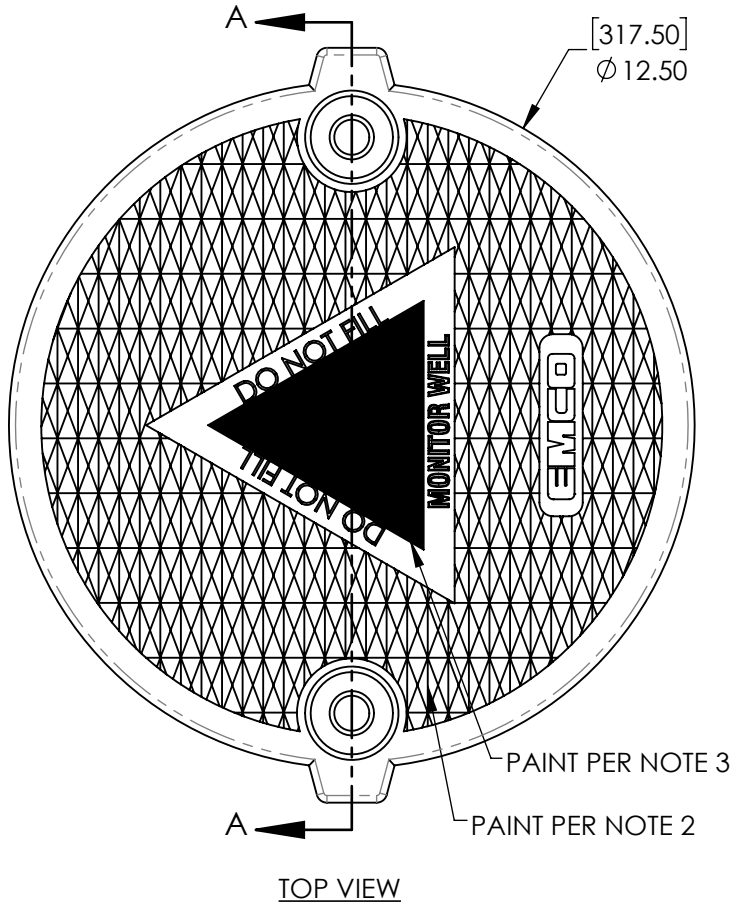

		EMCO WHEATON RETAIL CORP.			
		2300 INDUSTRIAL PARK DRIVE WILSON, N.C. 27893 emcoretail.com			
DO NOT SCALE DRAWING-WORK TO DIMENSIONS SHOWN DIMENSIONS ARE IN INCHES (DIMENSIONS IN BRACKETS ARE IN MILLIMETERS)					
UNLESS OTHERWISE SPECIFIED		THE INFORMATION AND DESIGN DISCLOSED BY AND THE COPYRIGHT IN THIS DRAWING ARE THE PROPERTY OF EMCO WHEATON RETAIL CORP. AND CANNOT BE USED WITHOUT WRITTEN PERMISSION.			
DECIMALS	.X ± .030 .XX ± .015 .XXX ± .005			ANGLES	± 1°
CASTING TOLERANCES TO INDUSTRY STANDARDS MACHINED SURFACES 125 RMS REMOVE ALL BURRS					
DRAWN BY	DATE	USED ON	CASTING NUMBER		
CMB	11/5/24				
A Marketing		11/5/24	CMB		
SYM	REVISIONS	DATE	BY		
PART DESCRIPTION					
LID, CAST IRON 12"		A0721, A0722			
SIZE	DRAWING NUMBER.	PAGE	REV.		
A	563980	1/1	A		

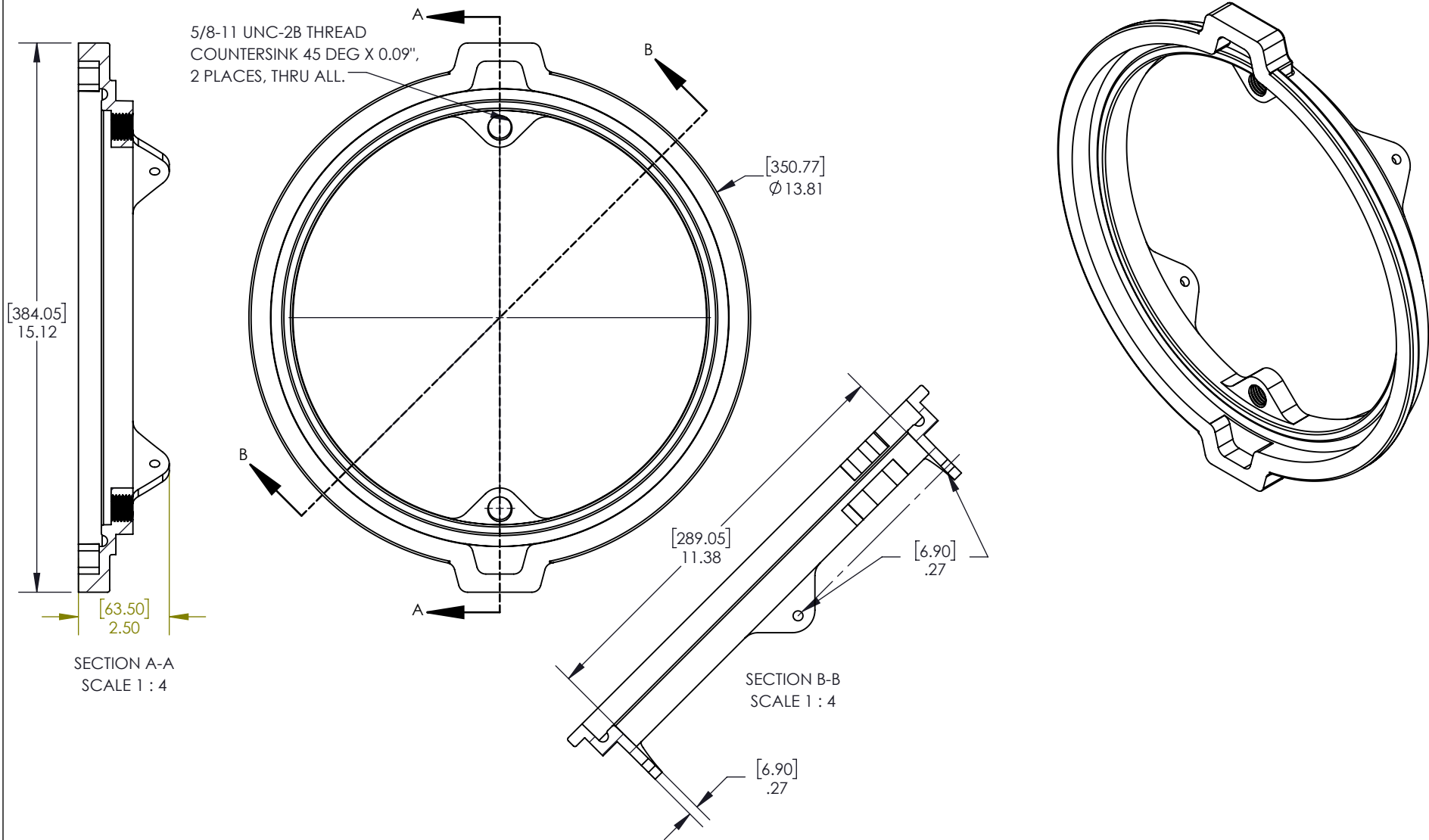

SECTION A-A
SCALE 1 : 4

SECTION B-B
SCALE 1 : 4

NOTE:

1. MATERIAL: DUCTILE IRON 65-45-12.
2. COAT ENTIRE RIM WITH WHITE ENAMEL PAINT.
3. APPROXIMATE WEIGHT: 6 LBS. 2 OZ. (2.78 KG).



EMCO WHEATON RETAIL CORP.
2300 INDUSTRIAL PARK DRIVE
WILSON, N.C. 27893
emcoretail.com

DO NOT SCALE DRAWING-WORK TO DIMENSIONS SHOWN
DIMENSIONS ARE IN INCHES (DIMENSIONS IN BRACKETS ARE IN MILLIMETERS)

UNLESS OTHERWISE SPECIFIED
DECIMALS .X ± .030 .XX ± .015 .XXX ± .005 ANGLES ± 1°
CASTING TOLERANCES TO INDUSTRY STANDARDS
MACHINED SURFACES 125 RMS REMOVE ALL BURRS

THE INFORMATION AND DESIGN DISCLOSED BY AND THE COPYRIGHT IN THIS DRAWING ARE THE PROPERTY OF EMCO WHEATON RETAIL CORP. AND CANNOT BE USED WITHOUT WRITTEN PERMISSION.

DRAWN BY	USED ON	CASTING NUMBER
CMB	A0721, A0722	

A	MARKETING	11/5/24	CMB
REV.	DESCRIPTION	DATE	BY
PART DESCRIPTION			
RIM, DUCTILE 12"			
SIZE	DRAWING NUMBER.	PAGE	REV.
A	563982	1/1	A